

Bellows suction pads (round)

Series VTCN - 2,5 folds



Series VTCN bellows suction pads, available in NBR or Silicone.
Diameters from 5 to 52 mm with thread size M3, M5, G1/8, G1/4, both male and female.



Series VTCN bellows suction pads (2,5 folds) have a rugged design and consist of a nipple and rubber part. The nipples are inserted directly into the rubber part. The rubber parts can also be ordered separately without nipples as spare parts. Materials: NBR or Silicone

Applications:

- Handling of even or uneven workpieces such as plates for car bodies, tubes, cardboard boxes
- Handling of fragile workpieces such as electronics components, injection moulded pieces, etc
- Handling of welded pieces
- Silicone version for handling of pieces at high temperatures

- » Optimal damping when placed on the workpiece.
- » Thanks to the optimised profile it can be used in systems with medium-short cycle times.
- » Good adaptation to curved and uneven surfaces.
- » Very stiff top fold to guarantee stability even in conditions with high accelerations or during emergency stops.
- » Good adaptation to different heights of the workpieces.

GENERAL DATA

Description	wear resistant suction pad consisting of rubber part VTCN with 2,5 folds and connection nipple
Construction	nipples and suction pads are supplied not pre-assembled
Maintenance	it is possible to replace the rubber part
Working temperature	NBR version: -30°C ÷ +120°C (for short time <30 sec.); -10°C ÷ +70°C (long-term) SILICONE version: -40°C ÷ +220°C (for short time <30 sec.); -30°C ÷ +180°C (long-term)

TECHNICAL DATA

SERIES VTCN BELLOWS SUCTION PADS

Mod./Diameter	Suction force (N)*	Pull-off force (N)**	Volume (cm ³)	Min. curve radius (mm) (convex)	Recommended internal tube diameter (mm)
VTCN-030	0,2	0,4	0,022	4	2
VTCN-040	0,3	0,6	0,053	4	2
VTCN-050	0,1	0,8	0,033	2	2
VTCN-070	0,1	0,9	0,043	3	4
VTCN-090	0,7	2,3	0,15	5	4
VTCN-120	0,9	3,5	0,6	6	4
VTCN-140	1,2	5,7	0,975	7	4
VTCN-180	2,3	8,5	1,35	9	4
VTCN-200	3,8	12,1	2	10	4
VTCN-250	4,5	19	5,4	12	4
VTCN-320	12	36,9	10	17	6
VTCN-420	13,6	44	19,5	24	6
VTCN-520	27	96	62	35	6

CODING EXAMPLE

VT	C	N	-	030	N	-	M5	M
-----------	----------	----------	----------	------------	----------	----------	-----------	----------

VT	SERIES VT = suction pad
C	SHAPE C = round
N	VERSION N = bellows, 2,5 folds
030	DIAMETERS 030 = 3,0 mm 040 = 4,0 mm 050 = 5,0 mm 070 = 7,0 mm 090 = 9,0 mm 120 = 12,0 mm 140 = 14,0 mm 180 = 18,0 mm 200 = 20,0 mm 250 = 25,0 mm 320 = 32,0 mm 420 = 42,0 mm 520 = 52,0 mm
N	MATERIALS N = NBR S = silicone
M5	THREAD SIZE M3 = M3 M5 = M5 1/8 = G1/8 1/4 = G1/4
M	THREAD M = male F = female

Series VTCN suction pad - male thread



* = (N) for suction pad in NBR - (S) for suction pad in Silicone
(add the required letter when placing an order)

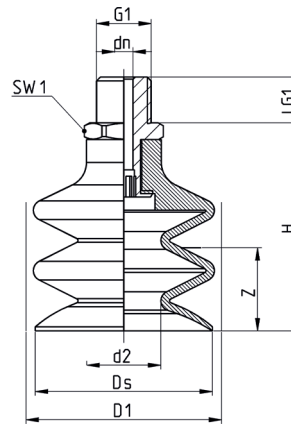

Tolerances for elastomer parts according to DIN ISO 3302-1 M3



DIMENSIONS										
Suction pad with nipple	D1	dn	Ds	G1	H	LG1	SW1	Z	Suction pad	Nipple
VTCN-030*-M3M	3,3	1,0	3,0	M3 M	8,7	3,0	5	1,1	VTCN-030*	NPS-G-M3-M
VTCN-030*-M5M	3,3	1,0	3,0	M5 M	10,2	4,5	7	1,1	VTCN-030*	NPS-A-M5-M
VTCN-040*-M5M	4,1	2,0	3,8	M5 M	19	5,0	8	1,5	VTCN-040*	NPV-E-M5-M
VTCN-050*-M5M	5,5	2,0	5,0	M5 M	18,5	5,0	8	2,0	VTCN-050*	NPV-E-M5-M
VTCN-070*-M5M	6,5	2,5	5,9	M5 M	19	5,0	7	4,0	VTCN-070*	NPV-D-M5-M
VTCN-070*-1/8M	6,5	3,5	5,9	G1/8 M	20	7,5	14	4,0	VTCN-070*	NPV-R-1/8-M
VTCN-090*-M5M	9,3	2,5	9,0	M5 M	20	5,0	7	3,0	VTCN-090*	NPV-D-M5-M
VTCN-090*-1/8M	9,3	3,5	9,0	G1/8 M	21	7,5	14	3,0	VTCN-090*	NPV-R-1/8-M
VTCN-120*-M5M	12,7	2,5	12,0	M5 M	26	5,0	7	6,0	VTCN-120*	NPV-D-M5-M
VTCN-120*-1/8M	12,7	3,5	12,0	G1/8 M	27	7,5	14	6,0	VTCN-120*	NPV-R-1/8-M
VTCN-140*-M5M	15,0	2,5	14,5	M5 M	27	5,0	7	8,0	VTCN-140*	NPV-D-M5-M
VTCN-140*-1/8M	15,0	3,5	14,5	G1/8 M	28	7,5	14	8,0	VTCN-140*	NPV-R-1/8-M
VTCN-180*-M5M	18,5	2,5	17,2	M5 M	27	5,0	7	8,0	VTCN-180*	NPV-D-M5-M
VTCN-180*-1/8M	18,5	3,5	17,2	G1/8 M	28	7,5	14	8,0	VTCN-180*	NPV-R-1/8-M

Series VTCN suction pad - female thread



* = (N) for suction pad in NBR - (S) for suction pad in Silicone
(add the required letter when placing an order)

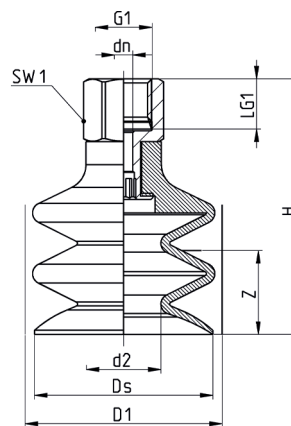

Tolerances for elastomer parts according to DIN ISO 3302-1 M3



DIMENSIONS										
Suction pad with nipple	D1	dn	Ds	G1	H	LG1	SW1	Z	Suction pad	Nipple
VTCN-040*-M5F	4,1	2,0	3,8	M5 F	24	5,5	88	1,5	VTCN-040*	NPV-E-M5-F
VTCN-050*-M5F	5,5	2,0	5,0	M5 F	24	5,0	8	2,0	VTCN-050*	NPV-E-M5-F
VTCN-070*-1/8F	6,5	3,5	5,9	G1/8 F	26	8,5	14	4,0	VTCN-070*	NPV-R-1/8-F
VTCN-090*-1/8F	9,3	3,5	9,0	G1/8 F	27	8,5	14	3,0	VTCN-090*	NPV-R-1/8-F
VTCN-120*-1/8F	12,7	3,5	12,0	G1/8 F	33	8,5	14	6,0	VTCN-120*	NPV-R-1/8-F
VTCN-140*-1/8F	15,0	3,5	14,5	G1/8 F	34	8,5	14	8,0	VTCN-140*	NPV-R-1/8-F
VTCN-180*-1/8F	18,5	3,5	17,2	G1/8 F	34	8,5	14	8,0	VTCN-180*	NPV-R-1/8-F
VTCN-200*-1/8F	20,0	3,5	20,0	G1/8 F	34	8,5	14	8,0	VTCN-200*	NPV-R-1/8-F
VTCN-250*-1/8F	24,7	3,5	23,0	G1/8 F	46	8,5	14	20,0	VTCN-250*	NPV-R-1/8-F
VTCN-320*-1/4F	32,6	4,4	32,0	G1/4 F	52,5	12,0	17	16,0	VTCN-320*	NPV-S-1/4-F
VTCN-420*-1/4F	43,5	4,4	42,6	G1/4 F	61	12,0	17	23,0	VTCN-420*	NPV-S-1/4-F
VTCN-520*-1/4F	52,5	4,4	52,5	G1/4 F	64	12,0	17	27,0	VTCN-520*	NPV-S-1/4-F